

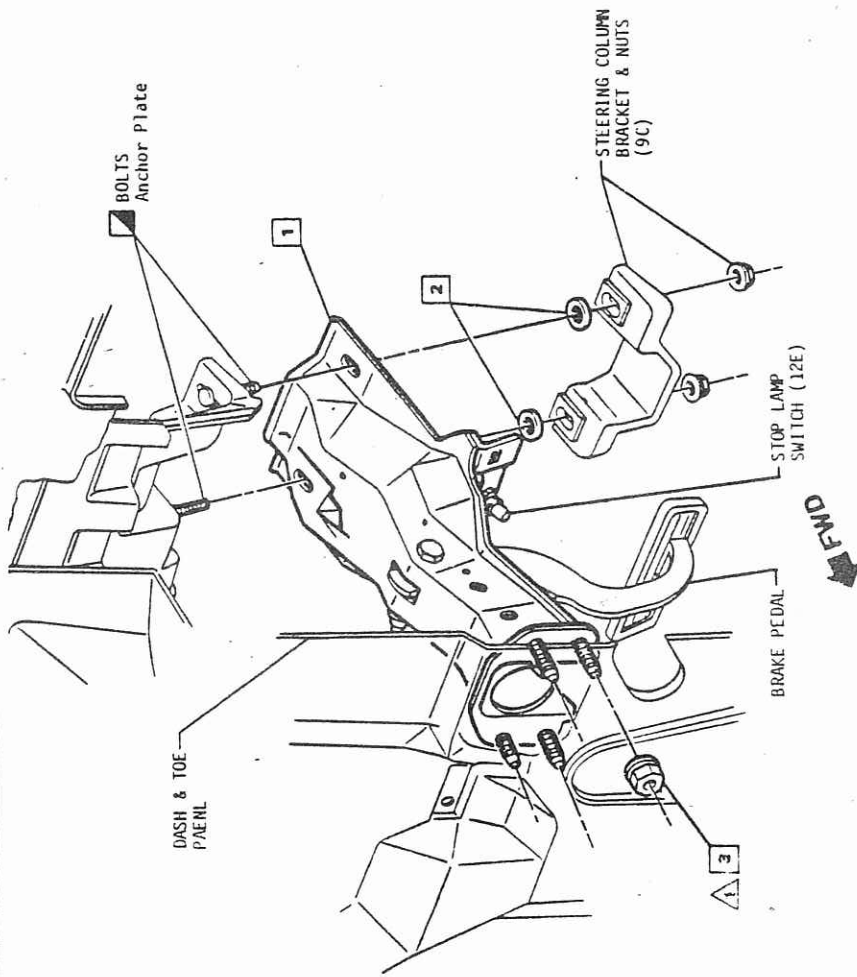

- 14003631   **1**   BRACKET ASM
- 11501849   **2**   RETAINER
- 14000393   **3**   NUT



DYNAMIC (Instal) / HAND (exp.) / Pm	DATE	SYN	REVISION	AUTH	DI	CE	APP	DATE	BY	CHK	DATE	BY	CHK	DATE	BY	CHK	DATE	BY	CHK
20 - 34	△																		
20 - 34	△																		
	△																		
	△																		
	△																		
	△																		
	△																		
FULLY DRYER, SEALED & NOT STOPPED																			
CA	XB	B	O	P	X	Ca													

**1981 CHEV. "F" 14020867**

**CHEVROLET**

TITLE: BRAKE PEDAL BRACKET  
 FA00 ALL

REV: ECR 86448  
 NEW 10/28/79

UFC: 91235 S  
 18840 S

SHEET: 5C  
 1



General Motors Corporation  
CHEVROLET MOTOR DIVISION

# PRODUCT DESCRIPTION MANUAL

ITEM REFERENCE     PROCESS MATERIAL     TORQUE     EXISTING AS PART OF

- 1 PEDAL ASM M24 or M64
- exc M24 or M64
- 2 BUSHING
- 3 SPACER
- 4 COVER M24 or M64
- exc M24 or M64
- 5 NUT
- 6 BOLT /SCREW & M24 or M64
- exc M24 or M64
- 7 WASHER M24 or M64

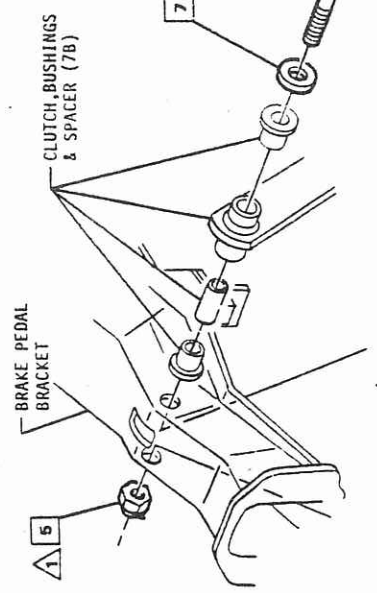
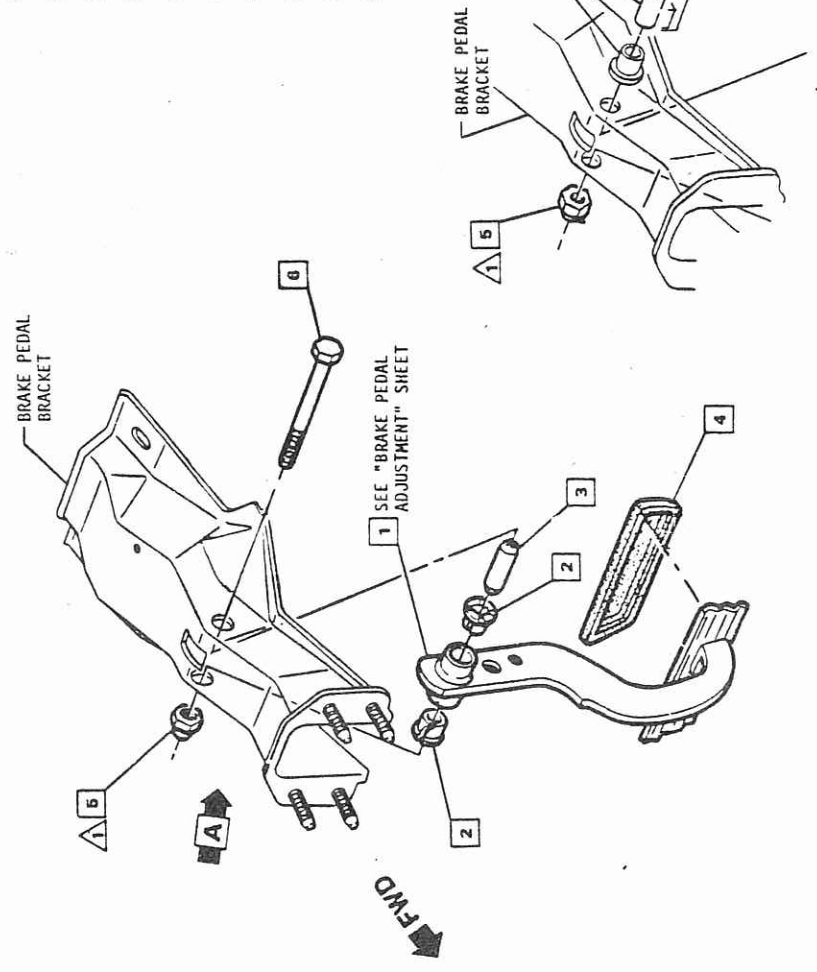

**VIEW A**  
 M24 or M64

DYNAMIC (incl) Vm	HAND (resp.) - Mm	DATE	SYM	REVISION	AUTN	DE	CK	CHK	ASM	DATE	DIV	TITLE	SHEET
△	26-48									11-24-80	CHEVROLET	1981 CHEV. "F" 14020867	2
△										DE AG FIELDING/EL		BRAKE PEDAL	
△										CK Campbell et al		FA00 ALL	
△										APPE			
△										APPE			
△										APPE			
△										APPE			
162													
EQUALLY DRIVER, SEATED & NOT STRIPPED													
△	△	△	△	△	△	△	△	△	△	△	△	△	△
△	△	△	△	△	△	△	△	△	△	△	△	△	△

C     D     O     P     Ca

- ITEM REFERENCE
  - PROCESS MATERIAL
  - TORQUE
  - EXISTING AS PART OF
- 
- |         |          |  |
|---------|----------|--|
| 3975544 | <b>1</b> | PIN  |
| 410230  | <b>2</b> | WASHER   |
| 3817880 | <b>3</b> | RETAINER   |
| 9985164 | <b>A</b> | GREASE-Approx<br>.013 LBS on O.D.<br>of Pin per job. |

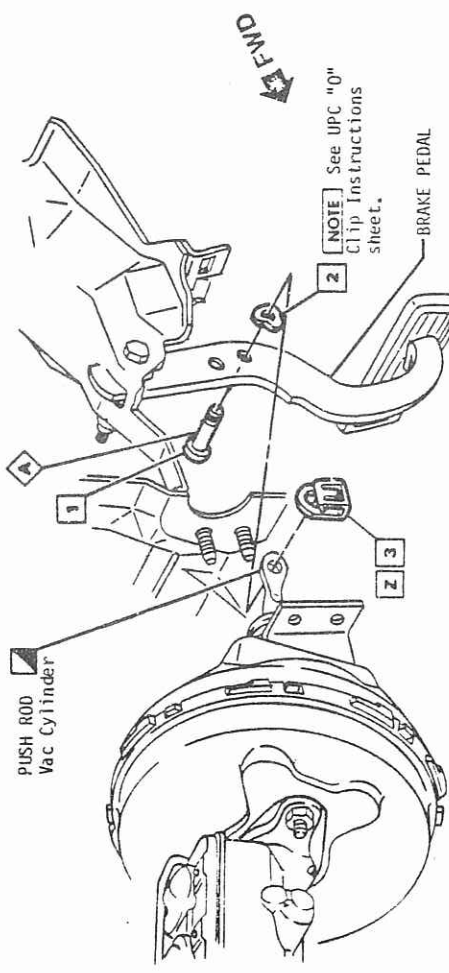

Retainer **3** MUST scribe a legible line on end of clevis pin **1** during assembly. Avoid any expanding tool which nullifies this intent.

DATE	SYN	REVISION	AUTH	DR	CE	REV	DATE	BY
							11/21/79	DR R.G. FIELDING/EM
								CE [Signature]
								APPR [Signature]
								APPR [Signature]
								APPR [Signature]
								APPR [Signature]

<b>1981 CHEV. "F" 14020867</b>	
TITLE BRAKE PEDAL PUSH ROD FA00 ALL	
DIV CHEVROLET	BIF ECR 86448 NEW 12/02/79
UPC 05346 S 08183 S 18840 S 19262 S	SHEET <b>5C</b> <b>3</b>

FULLY DRIVEN, SEALED & NOT STRIPPED

X B O P X G

- 1** 344625 PEDAL & LEVER ASM
- 2** 1359887 NUT
- 3** 3886787 BOLT/SCREW
- 4** 3982308 STUD
- A** 9980664 ADHESIVE -  
Approx. .10 OZ per Job.

**Z** If this Bolt/Screw is tightened first, Parking Brake Asm must be held in forward most position during tightening.

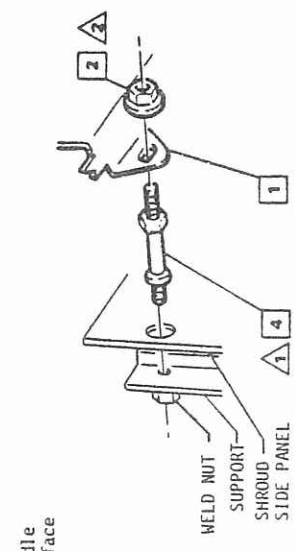
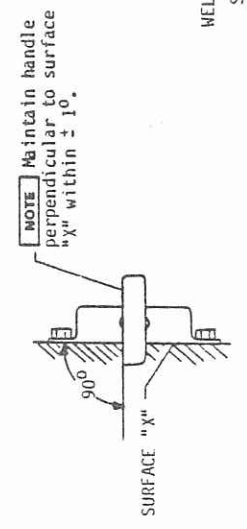
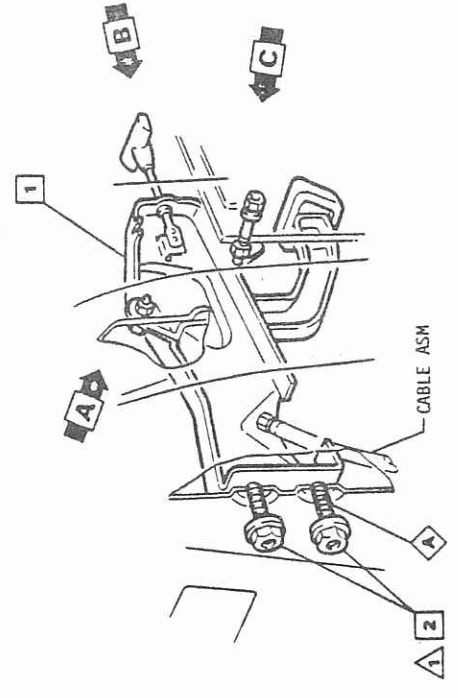

**NOTE** Maintain handle perpendicular to surface "X" within ± 1°.

VIEW B      VIEW A      VIEW C

DATE	REVISED	DATE	REVISED	DATE	REVISED	DATE	REVISED
9 - 14		DR R/G	FILLING/CJM	11/1/80			
14 - 20		CE					
		APPR					
		APPR					
		APPR					
		APPR					
				334			
AUTOMATICALLY SEATED & NOT STRIPPED							

GM	B	0	P	G	G
----	---	---	---	---	---

  

<b>1981 CHEV. "F" 14020867</b>	
<b>CHEVROLET</b>	TITLE PARKING BRAKE PEDAL & LEVER FAO ALL
JIT ECR 86448 C/O 100E79 50-1	UPC 1-08333 S 1-89731 S 1-16962 S
5D	SHEET 1

- 1 CABLE ASM
- 2 BOLT/SCREW
- 3 CLIP
- 4 WASHER
- 5 NUT
- 6 RETAINER
- 7 RETAINER
- 7 OPT

- 344682
- 11500086
- 340394
- 103330
- 103029
- 1385078
- 516213
- 1261218

ITEM REFERENCE  PROCESS MATERIAL  TORQUE

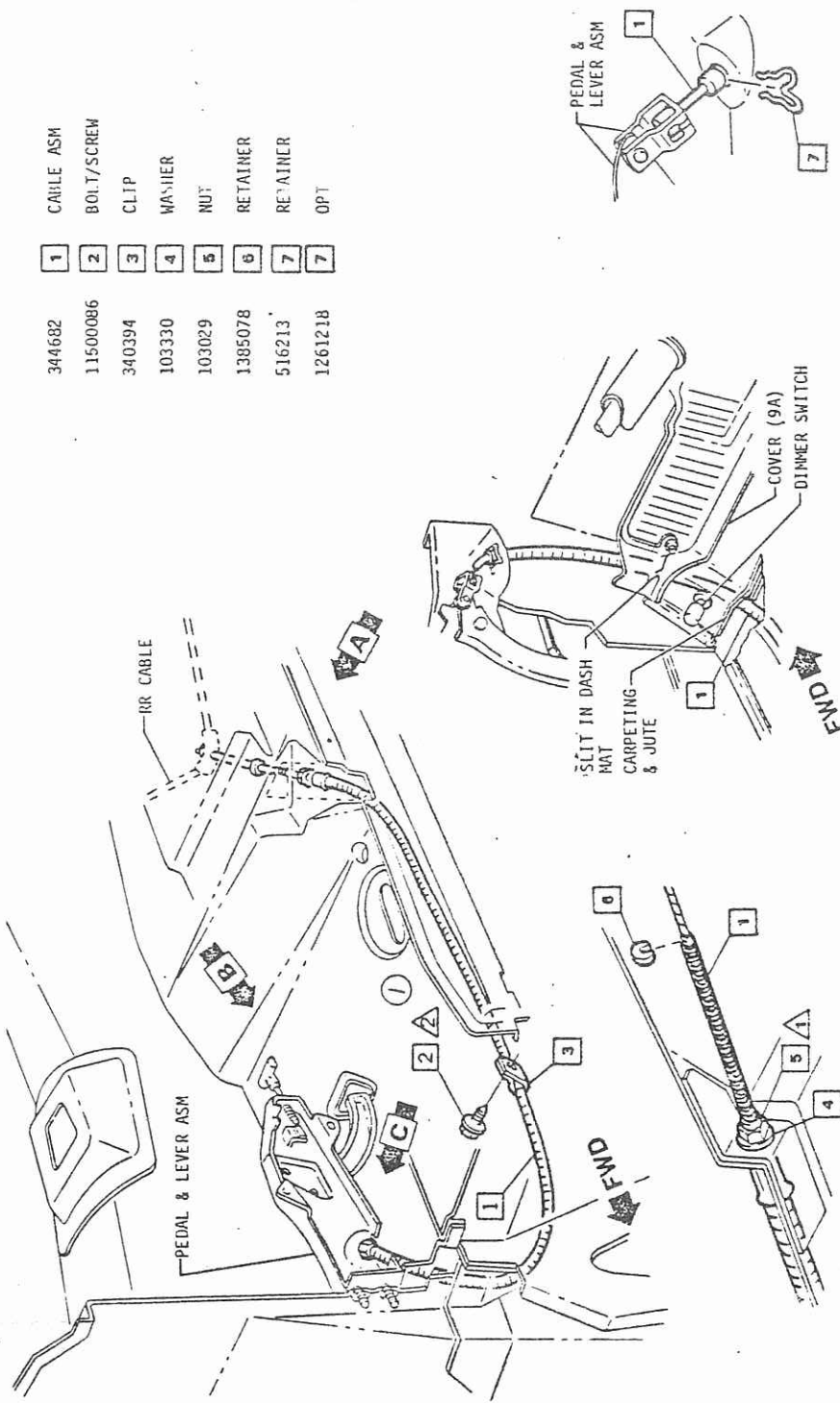

VIEW C

VIEW B

VIEW A

1981 CHEV. "F" 14020867		DIV		DATE		AUTH		REVISION		DATE		SYM	
TITLE PARKING BRAKE FRONT CABLE FA00 ALL		CHEVROLET		11-2-80		DR AG FELDING/EMH		ITEMS 283 REMOVED & DRAWING REVISED		26-688		1	
MFR ECR 86448 C/C 100E79 50-2		UPC L- 08353 S L- 16962 S		APPR 50									
SHEET 2		5D											

FULLY DRIVEN, SEATED & NOT STOPPED

G  F  P  O  D  C



General Motors Corporation  
**PRODUCT DESCRIPTION MANUAL**  
 EXISTING AS PART OF

General Motors Corporation  
**CHEVROLET MOTOR DIVISION**



ITEM REFERENCE    PROCESS MATERIAL    TORQUE    EXISTING AS PART OF

I. PRESTRETCH REQUIREMENT

PRIOR TO ADJUSTMENT AND WITH SYSTEM ASSEMBLED, THE LATTER CENTER CABLE MUST BE SUBJECTED TO A TENSILE FORCE OF AT LEAST 1334 NEWTONS CABLE TENSION BUT NOT MORE THAN 1779 NEWTONS FOR THREE (3) APPLICATIONS. THE CABLE MUST BE LOADED IN SUCH A MANNER AS NOT TO CAUSE ANY KINKS OR SET POINTS OTHER THAN AT THE EQUALIZER.

II. ADJUSTMENT PROCEDURE

ADJUST THE SYSTEM TO SPECIFICATIONS SUCH THAT A TORQUE OF 100 NEWTON METERS AT THE PARK BRAKE PEDAL WILL DEPRESS THE PEDAL AT LEAST SEVEN (7) CLICKS BUT NOT MORE THAN ELEVEN (11) CLICKS.

**NOTE** FOR PRODUCTION CONFORMANCE, THE ABOVE SPECIFICATION RELATES TO 1557-1779 NEWTONS OF STRAND TENSION IN THE CENTER CABLE AS MEASURED WITH A BURROUGHS CABLE TENSION GAGE B1-33-72LCA-150-400. THIS REFERENCE STRAND TENSION IS ONLY A PRODUCTION AID AND SHOULD NOT BE MISCONSTRUED TO BE AN ALTERNATE SPECIFICATION.

DYNAMIC (Insert) No.	HAND (loop) No.	DATE	SW	REVISION	AUTH	OR (K OR L) DATE	DATE (1/1/80) OR (AS RETURNED) OR ( )	DIV	CHEVROLET REF ECR 86048 C/G 100E79 50-4	TITLE 1981 CHEV. "F" 14C20867 PARKING BRAKE ADJUSTMENT PROCEDURE FA00 A1 L	UIC 5D	SHEET 4



**PRODUCT DESCRIPTION MANUAL**

ITEM REFERENCE  
  PROCESS MATERIAL  
  TORQUE  
  EXISTING AS PART OF

- 18008058    1    CYLINDER ASM
- 14000393    2    NUT
- 9985013    A    FLUID-HYD Approx .850 Liter

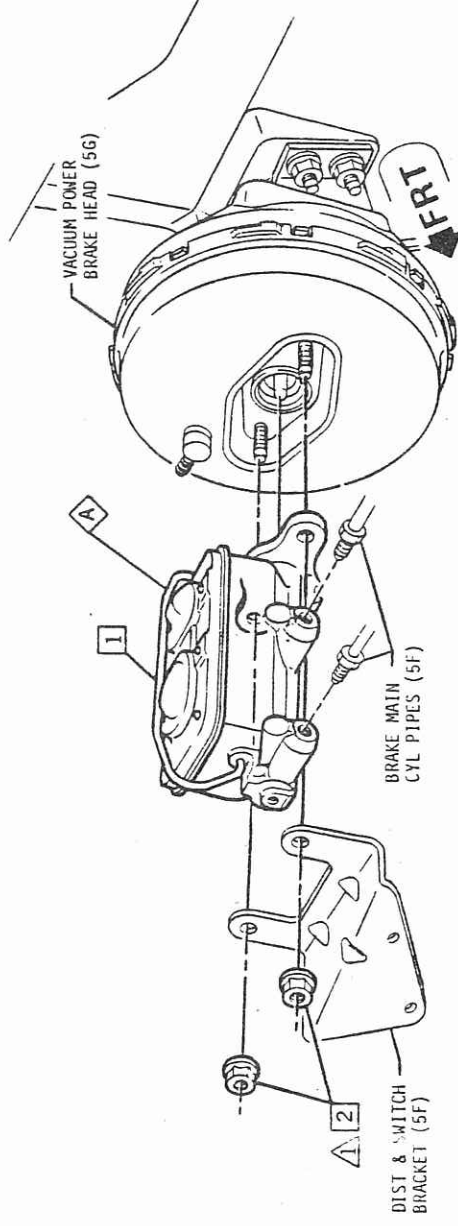

DATE	SYN	REVISION	AUTH	DR	CK	ENG	DATE	DIV	TITLE
04SE80	1	PLANNING & REV. (UNFIN)	9/27/02	FJM	RE	RE	11-24-80	CHEVROLET	1981 CHEV. "F" 14020867
05FES1	2	QTY LVA5 .164 GAL	04799	SM	RE	RE	DR AG FIELDING/EJM	CHEVROLET	BRAKE MAIN CYLINDER
02AP05	3	QTY LVA5 .225 GAL	04799	SM	RE	RE	CK Cmp/Sky/2H	CHEVROLET	FAOD ALL
							APPE 57		
							APPE	REF ECR 86448	
							APPE	NEW 100E79	5E
							APPE		

DYNAMIC (Instel) M-m  
 HAND (Inst.) - M-m  
 20 - 34  
 20 - 34  
 20 - 34

FULLY DRIVEN, SEALED & NOT STRIPPED



General Motors Corporation  
CHEVROLET MOTOR DIVISION

PRODUCT DESCRIPTION MANUAL

ITEM REFERENCE   
  PROCESS MATERIAL   
  TORQUE   
  EXISTING AS PART OF

- 14025071 **1** BRACKET
- 18008084 **2** VALVE ASM
- 25509418 **2** OPT
- 9432544 **3** BOLT/SCREW
- 14031575 **4** PIPE ASM-FRONT
- ⑨ 14031576 **5** PIPE ASM-REAR &LC3/LD5;  
-&LG4/LM1/L39 &J50
- ⑩ 10018543 **5** &LG4/LM1/L39 &JE1

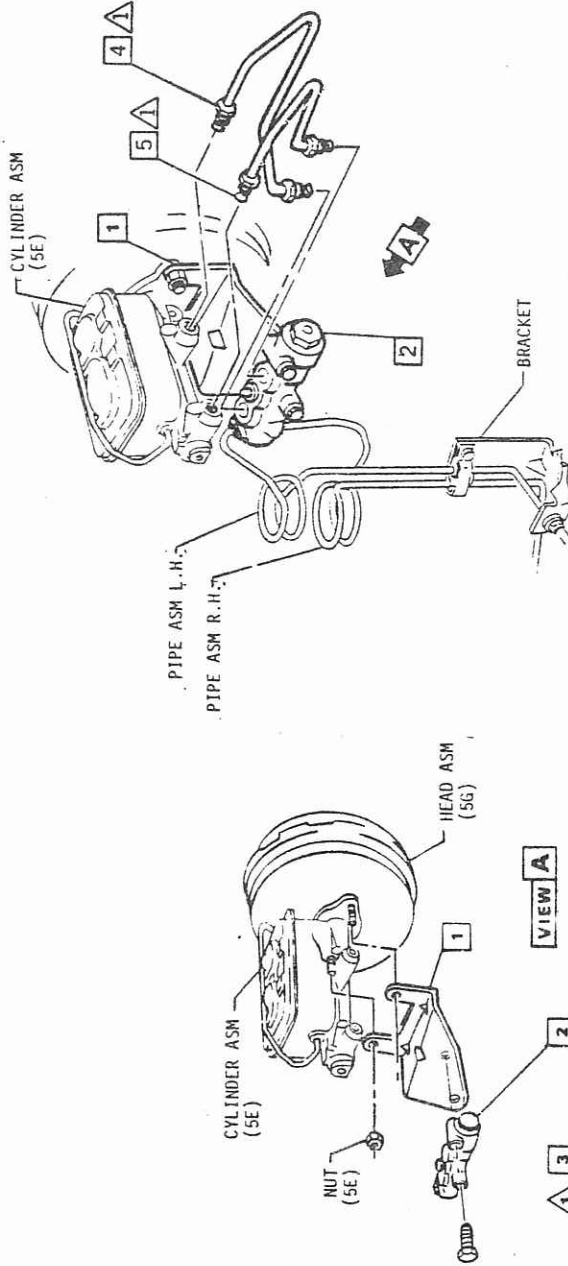

DYNAMIC (Invol./Nm)	HARD (Insp.) Nm	DATE	REV	REVISION	AUTH	DR	CK	AW	DATE	DATE	DIV	TITLE	UPC	SHEET
Δ 20-27		20-02-95	1	OPTIONS ADDED	03379				DE RC FIELDINGE JM	11/22/95	CHEVROLET	1981 CHEV. "F" 14020867	95892-5	1
Δ				10018543 PIPE ADDED					APPR S			FRONT BRAKE PIPES, VALVE ASM	96279-5	5F
Δ									APPR			FA00 ALL	25528-5	
Δ									APPR					
Δ									APPR					
Δ									APPR					
FULLY DRIVEN, SEALED & NOT STRIPPED														

Ch  
  B  
  0  
  P  
  Co



General Motors Corporation  
CHEVROLET MOTOR DIVISION

PRODUCT DESCRIPTION MANUAL

ITEM REFERENCE     PROCESS MATERIAL     TORQUE     EXISTING AS PART OF

- ⑨ 14031569 1 PIPE ASM LH V6; V8 & J50
- ⑩ 10012673 1 V8 & J50
- ⑪ 14031570 2 PIPE ASM RH V6; V8 & J50
- ⑫ 10010002 2 V8 & J50
- ⑬ 6264041 3 BRACKET LH V6; V8 & J50
- ⑭ 10012968 3 V8 & J50
- 11500086 4 BOLT/SCREW
- 9762808 5 HOSE ASM
- 14005646 5 OPT
- 14000172 6 WASHER
- 14000404 7 BOLT/SCREW
- 343464 8 CLIP exc LD5
- 484527 8 4LD5
- 6264042 9 BRACKET RH
- 3983038 10 INSULATOR
- 3982380 11 CLIP
- 334961 12 RETAINER

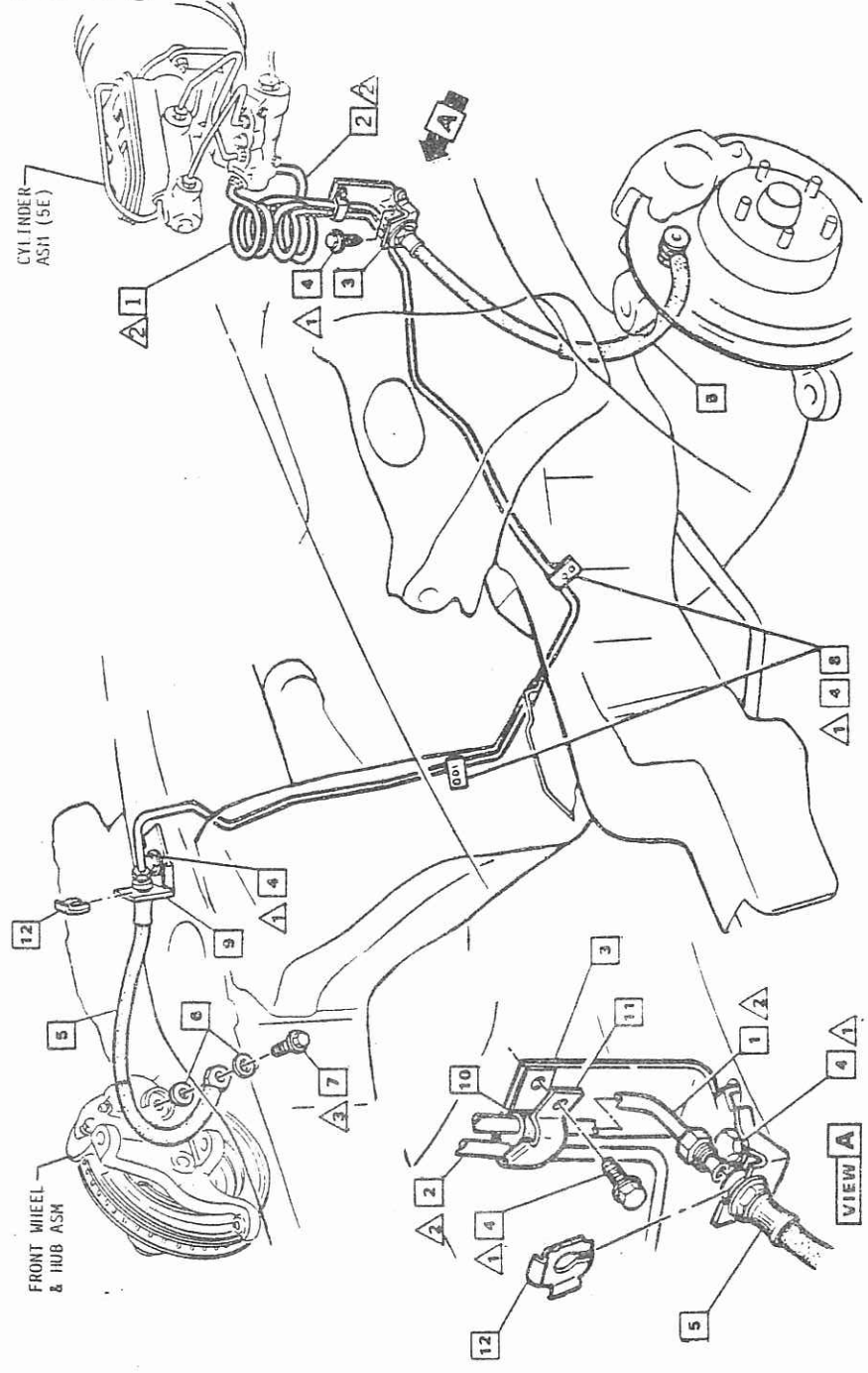

DATE	SW	REVISION	AUTH	DR	CE	SH	DATE	DATE	DIV	TITLE
7/19/81	9	OPTIONS ADDED							CHEVROLET	FRONT BRAKE PIPES
	10	10012673 PIPE ADDED							CHEVROLET	FAO ALL
	11	OPTIONS ADDED								
	12	10010002 PIPE ADDED								
	13	OPTIONS ADDED								
	14	10012968 BRACKET ADDED								

1981 CHEV. "F" 14020867	SHIFT	2
UPC	5F	
UFC		
1-96092-S		
1-96279-S		
1-23800-S		
1-25526-S		

FULLY DRIVER, SEATED & NOT STRIPPED  
 G  
 P  
 G

**PONTIAC MOTOR DIVISION**  
 General Motors Corporation  
 Pontiac, Michigan

**PRODUCT DESCRIPTION MANUAL**  
 EXISTING AS PART OF

- ITEM REFERENCE
- PROCESS MATERIAL
- TORQUE
- EXISTING AS PART OF

- 10013604  SHIELD
- 11500086  BOLT/SCREW

Z (POSITION #2)

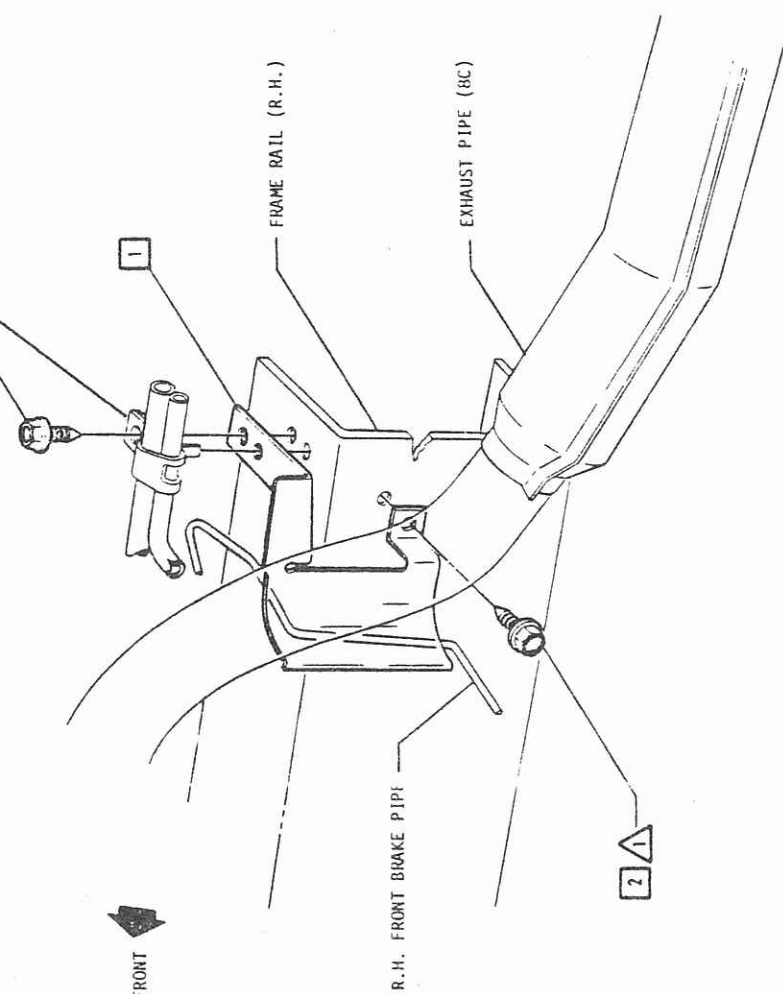

Z SEE UPC 88 SHEET-1 FOR PART NUMBERS.

DYNAMIC (INC) / N.M.	HAND (IMP.) / N.M.	DATE	SYM	ISSUE ID	REVISION	AUTH	DR	CE	AW	DATE / 4	NO	79	DIV	1981 CHEV. "F" 14020867
<input checked="" type="checkbox"/>	8-14	11/28/80		534180	1	171	906443	90222	5.0	DR	P	D	1	14020867
<input checked="" type="checkbox"/>														
<input checked="" type="checkbox"/>														
<input checked="" type="checkbox"/>														
<input checked="" type="checkbox"/>														
CHEVROLET REF ECR B644B C/O 10/18/79 5F-21														
R. H. BRAKE PIPE HEAT SHIELD FA00 & LUB														
SHEET 5 OF 5														

FULLY DRIVEN SEATED & NOT STRIPPED



# PRODUCT DESCRIPTION MANUAL

General Motors Corporation  
CHEVROLET MOTOR DIVISION

ITEM REFERENCE  PROCESS MATERIAL  TORQUE  EXISTING AS PART OF

- |    |          |                     |
|----|----------|---------------------|
| 1  | 14031572 | PIPE ASM-RH exc Z28 |
| 2  | 14031574 | 8Z28                |
| 3  | 1239146  | BOLT/SCREW          |
| 4  | 14031571 | PIPE ASM-LH exc Z28 |
| 5  | 14031573 | 8Z28                |
| 6  | 368119   | BRACKET             |
| 7  | 334961   | RETAINER            |
| 8  | 1251295  | HOSE ASM exc Z28    |
| 9  | 9757655  | OPT exc Z28         |
| 10 | 9761891  | 8Z28                |
| 11 | 368115   | CLIP                |
| 12 | 11500086 | BOLT/SCREW          |
| 13 | 459072   | BRACKET             |
| 14 | 11500191 | WASHER              |
| 15 | 9419030  | BOLT/SCREW          |
| 16 | 9419234  | WASHER              |
| 17 | 470798   | CLIP                |

- X Hose Installed Position has an approx 60° Twist.
- Y Form clip to securely retain pipes.
- Z See UPC "0" General Information - Clip Instructions.

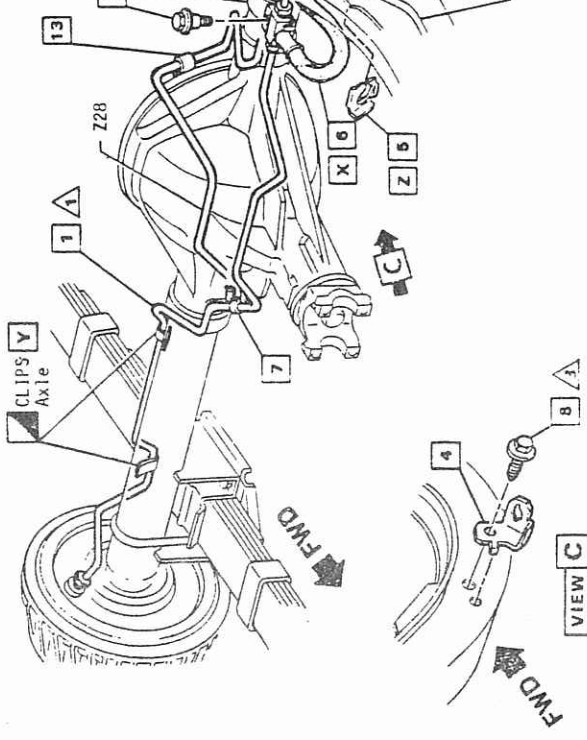
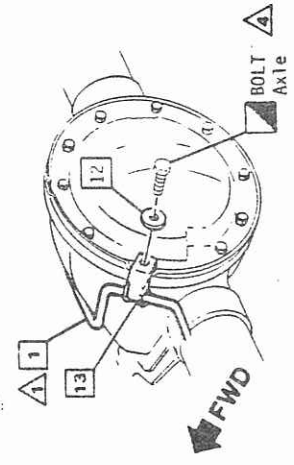
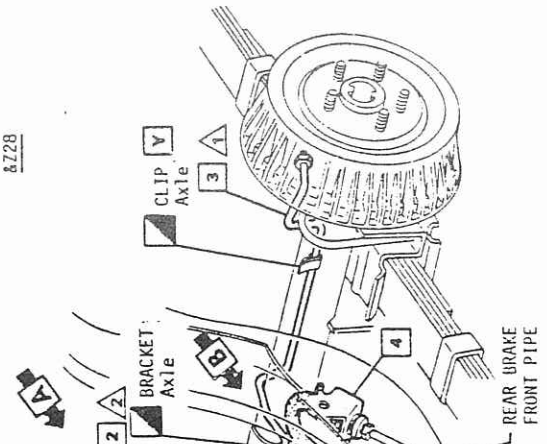
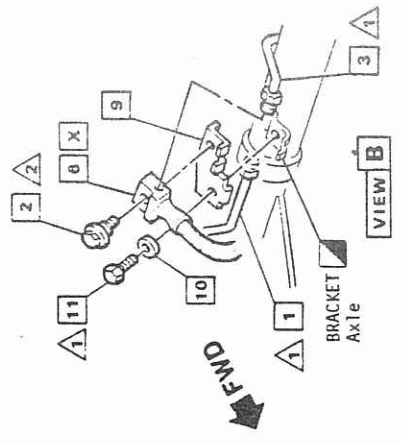

DYNAMIC (Instr) Pm	HAND (Imp.) - Hm	DATE	SYM	REVISION	AUTH	DE	CK	SM	DATE	DIV	TITLE																		
		20 JUN 80	4	MAS 14020294 PIPE					16/2/80	CHEVROLET	1981 CHEV. "F" 14020867																		
△ 20-27			5	14031574 MAS 14020296							REAR BRAKE-REAR PIPES																		
△ 11-16			6	MAS 14020293 PIPE							FAO ALL																		
△ 8-14			7	14031573 MAS 14020295																									
△ 20-34			8	MAS 14025038 BRACKET																									
△			9	9757655 MAS 9764545																									
△			10	9761891 MAS 9764544																									
FULLY DRIVEN, SEALED & NOT STRIPPED																													
<table border="1"> <tr> <td>REF</td> <td>ECR 86-148</td> <td>UPC</td> <td>1-13714-3</td> <td>SHEET</td> <td>5</td> </tr> <tr> <td></td> <td>C/O 100E79</td> <td></td> <td>1-13714-3</td> <td></td> <td></td> </tr> <tr> <td></td> <td>5F-4</td> <td></td> <td></td> <td></td> <td></td> </tr> </table>												REF	ECR 86-148	UPC	1-13714-3	SHEET	5		C/O 100E79		1-13714-3				5F-4				
REF	ECR 86-148	UPC	1-13714-3	SHEET	5																								
	C/O 100E79		1-13714-3																										
	5F-4																												

△ FULLY DRIVEN, SEALED & NOT STRIPPED

CH X B B O P X Cg



General Motors Corporation  
CHEVROLET MOTOR DIVISION

PRODUCT DESCRIPTION MANUAL

ITEM REFERENCE   
  PROCESS MATERIAL   
  TORQUE   
  EXISTING AS PART OF

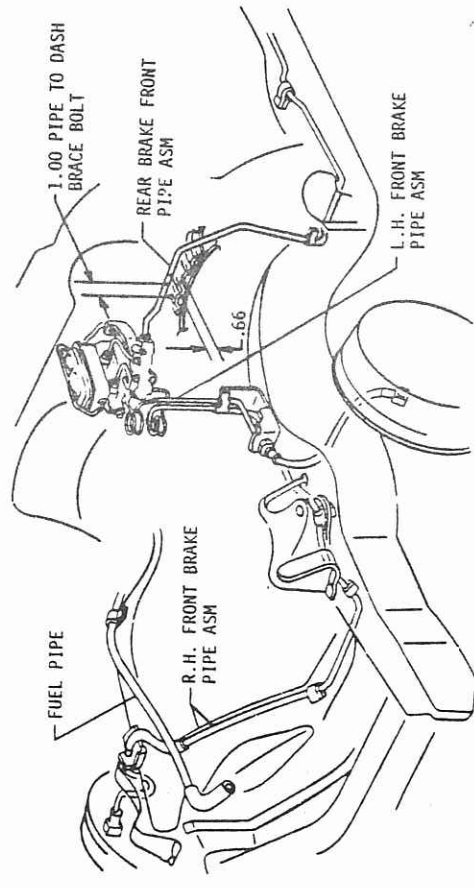
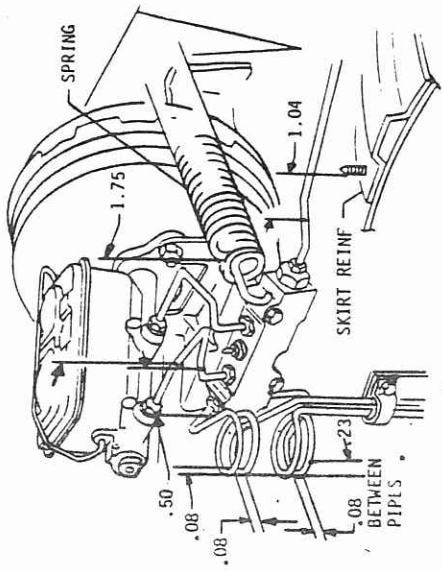

NOTE: All dimensions shown are minimum checking dimensions as installed.

DYNAMIC (Instal) New		HAND (Instal) New		DATE	SYM	REVISION		AUTH	DR	CE	ASH	DATE	DIV	TITLE				
<input checked="" type="checkbox"/>	<input checked="" type="checkbox"/>	<input checked="" type="checkbox"/>	<input checked="" type="checkbox"/>									1/14/80	CHEVROLET	1981 CHEV. "F" 14020867				
<input checked="" type="checkbox"/>	<input checked="" type="checkbox"/>	<input checked="" type="checkbox"/>	<input checked="" type="checkbox"/>									DR R G WELDING/LJM		BRAKE PIPE CLEARANCE DIMENSIONS				
<input checked="" type="checkbox"/>	<input checked="" type="checkbox"/>	<input checked="" type="checkbox"/>	<input checked="" type="checkbox"/>									APPR		-FA00 ALL				
<input checked="" type="checkbox"/>	<input checked="" type="checkbox"/>	<input checked="" type="checkbox"/>	<input checked="" type="checkbox"/>									APPR		L-91235-S				
<input checked="" type="checkbox"/>	<input checked="" type="checkbox"/>	<input checked="" type="checkbox"/>	<input checked="" type="checkbox"/>									APPR		L-92854-S				
<input checked="" type="checkbox"/>	<input checked="" type="checkbox"/>	<input checked="" type="checkbox"/>	<input checked="" type="checkbox"/>									APPR		L-				
													REF	ECR 86448	UPK	5F	SHEET	6
													C/O	100K79				
														5F-5				

FULLY DRIVEN, SEALED & NOT STOPPED  
 C   
  B   
  O   
  P   
  G

□ ITEM REFERENCE    ◇ PROCESS MATERIAL    △ TORQUE    ▣ EXISTING AS PART OF

18007257    [1] BOOSTER ASM

[2] ① 18006557    [1] &JE1

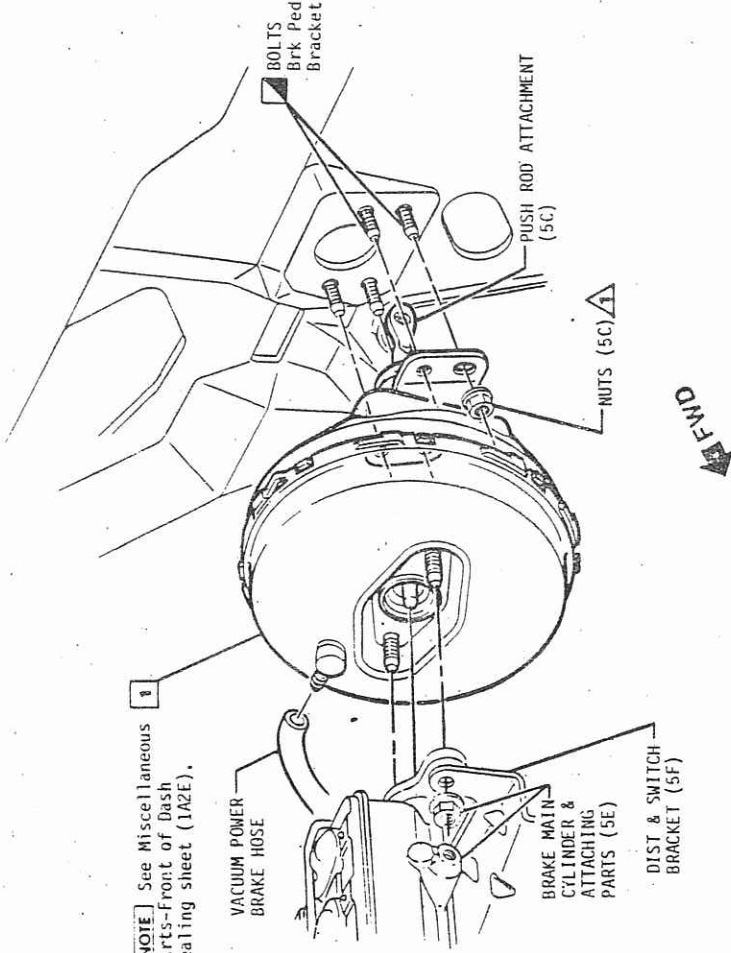

DATE	SYN	REVISION	AUTH	DR	CHK	ESN	DATE	DIV	TITLE	REF	UFC	SHEET
23 AUG 1980	1	18007257 - ASSEMBLY REMOVED	91222	5/8/80	DR	DR	HG FIELDN/ECH	CHEVROLET	VACUUM POWER BRAKE BOOSTER A/H	1- 08183 S 1- 91235 S 1- 18842 S	5G	1
	2	18006557 - JE1 ADDED	22563	MIJ/ET	CK		DR/SH/ET		F400 ALL			
							APPE S					
							APPE					
							APPE					
							APPE					
							APPE					

△ FULLY DRIVEN, SEALED & NOT STRIPPED

CH X B 0 P X CG





General Motors Corporation  
CHEVROLET MOTOR DIVISION

PRODUCT DESCRIPTION MANUAL

ITEM REFERENCE PROCESS MATERIAL TORQUE EXISTING AS PART OF

- 1 HOSE
- 2 PIPE ASM
- 3 FITTING
- 4 CLAMP
- 5 HOSE
- 6 FILTER ASM
- 7 NUT exc C60
- 8 WASHER exc C60
- 9 LUB-RUBBER  
Approx. 0.004L per hose (both ends).

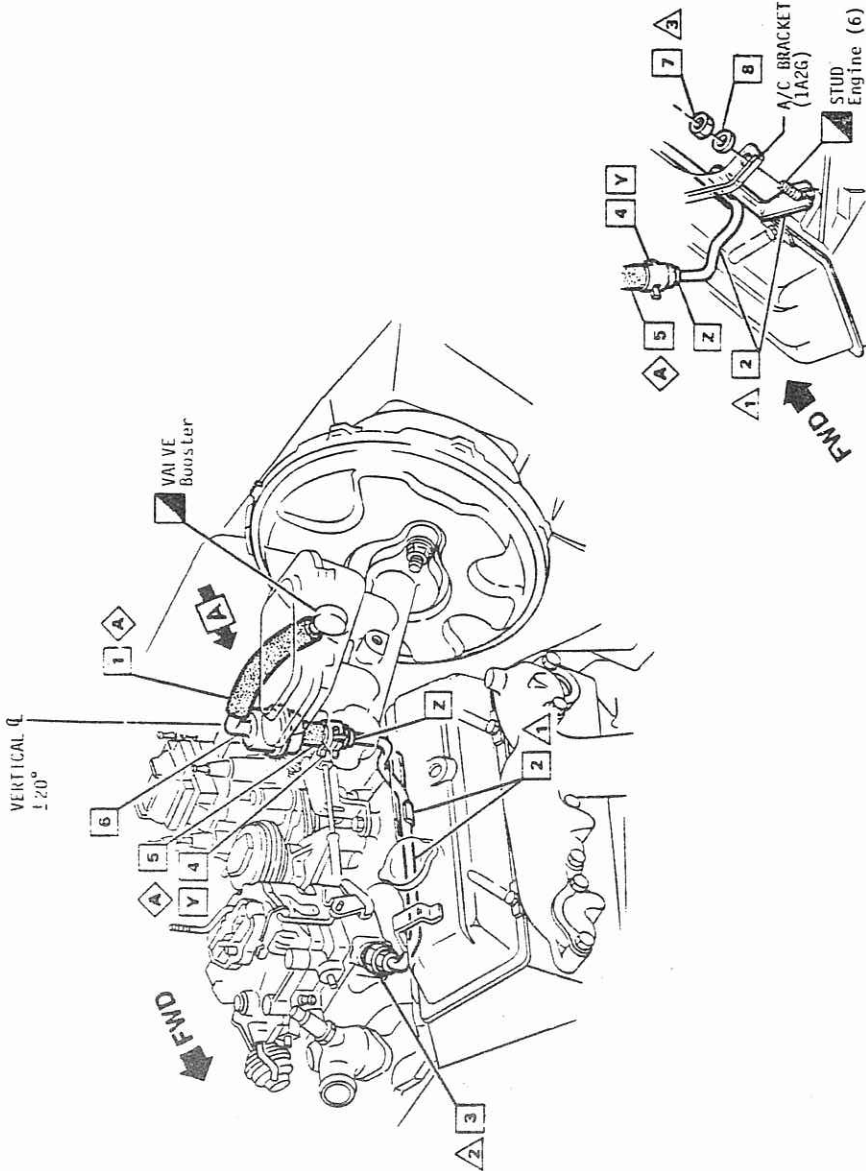

- Y See UPC "0" General Information  
Hose Clamping Instructions.
- Z Install hose to bead stop on pipe.

DATE	REV	DESCRIPTION
8-11-80	1	WAS 9985-234 (11B)
9-5-80	2	TORQUE 8-11 WAS 8.5-11.3
	3	TORQUE 11-14 WAS 11.3-14.1
	4	TORQUE 26-40 WAS 27-40
	5	WAS 1705-236 FILTER ASM
	6	QUANTITY WAS .0038 L

DATE	CHK	DATE	CHK	DATE	CHK
10/27/80		11/13/80		11/13/80	

DATE	CHK	DATE	CHK	DATE	CHK
11/13/80		11/13/80		11/13/80	

1981 CHEV. "F" 14020867	CHEVROLET	1-22344	UPC	56	SHEET	2
VACUUM POWER BRAKE HOSES, PIPE & FILTER	FA00 BLC3	L-10DE79				
REF ECR 86448	C/O 10DE79					

AD FULLY DRIVEN, SEALED & NOT STRIPPED

**PONTIAC MOTOR DIVISION**  
 General Motors Corporation  
 Pontiac, Michigan

**PRODUCT DESCRIPTION MANUAL**  
 ITEM REFERENCE PROCESS MATERIAL TORQUE EXISTING AS PART OF

- 3829058 [1] CLAMP
- 10014406 [2] HOSE
- (2) 17070814 [3] FILTER
- 9437601 [4] HOSE
- (1) 9985406 [A] LUBRICANT

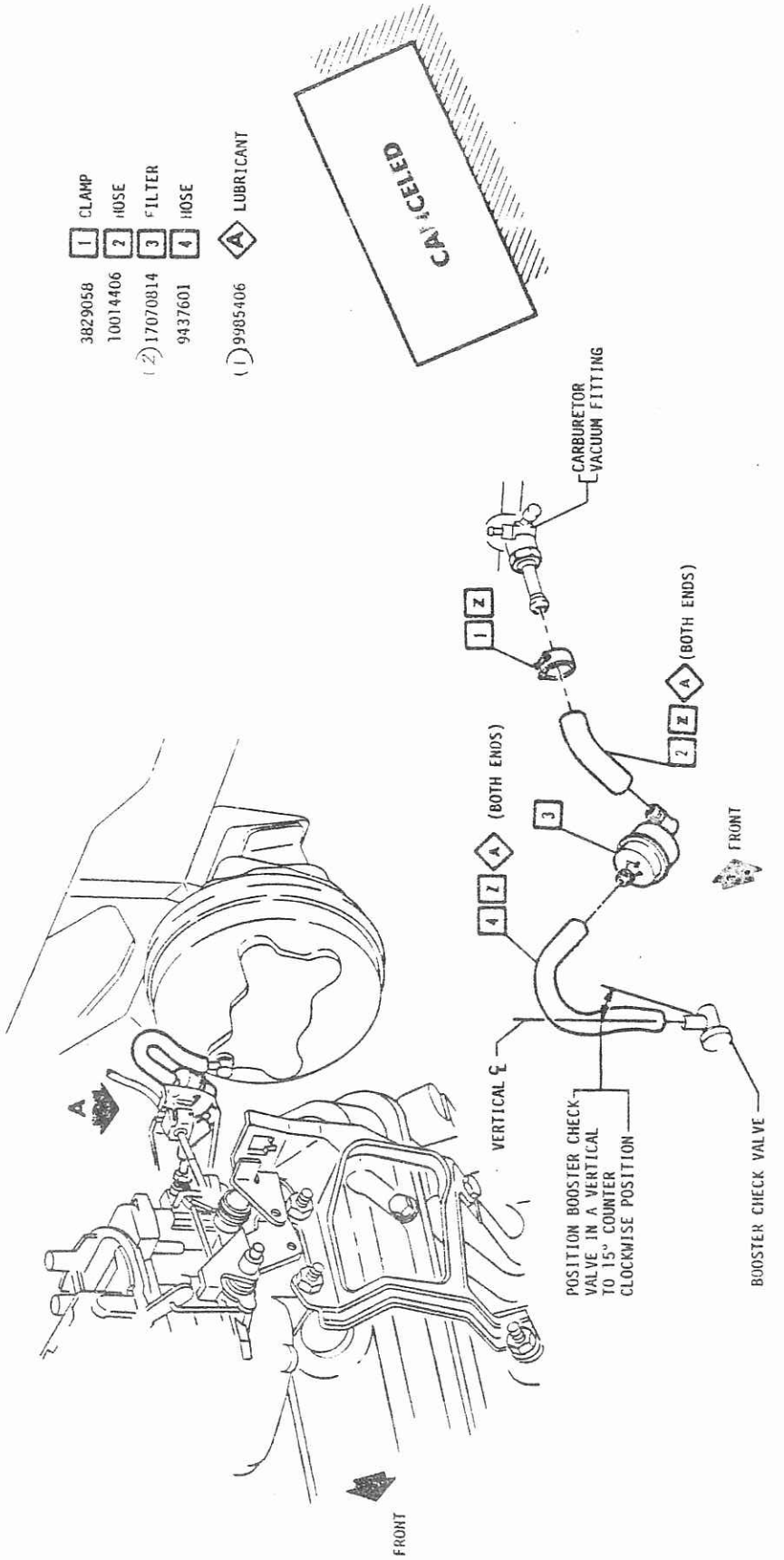

[Z] SEE FASTENER GENERAL INSTRUCTIONS FOR PROPER INSTALLATION (GROUP 0A)

DATE		SYN	REVISION		DATE	BY	CHK	CR	DATE	DIV	TITLE	
1/22/80	1	ISSUED	1	1	1/22/80	JEB				CHEVROLET	1981 CHEV. "F" 14020867	
2/11/80	2	WAS 998523+ LUB	2	2	2/11/80	JEB				CHEVROLET	VACUUM POWER BRAKE HOSE	
2/11/80	3	WAS 17056236 FILTER	3	3	2/11/80	JEB				CHEVROLET	FAOU & LUB	
2/11/80	3	SHEET CANCELLED	3	3	2/11/80	JEB				CHEVROLET	FAOU & LUB	
DATE		SYN	REVISION		DATE	BY	CHK	CR	DATE	DIV	TITLE	
1/17/79	1	ISSUED	1	1	1/17/79	JEB				CHEVROLET	VACUUM POWER BRAKE HOSE	
1/17/79	2	WAS 998523+ LUB	2	2	1/17/79	JEB				CHEVROLET	FAOU & LUB	
1/17/79	3	WAS 17056236 FILTER	3	3	1/17/79	JEB				CHEVROLET	FAOU & LUB	
1/17/79	3	SHEET CANCELLED	3	3	1/17/79	JEB				CHEVROLET	FAOU & LUB	
DATE		SYN	REVISION		DATE	BY	CHK	CR	DATE	DIV	TITLE	
1/17/79	1	ISSUED	1	1	1/17/79	JEB				CHEVROLET	VACUUM POWER BRAKE HOSE	
1/17/79	2	WAS 998523+ LUB	2	2	1/17/79	JEB				CHEVROLET	FAOU & LUB	
1/17/79	3	WAS 17056236 FILTER	3	3	1/17/79	JEB				CHEVROLET	FAOU & LUB	
1/17/79	3	SHEET CANCELLED	3	3	1/17/79	JEB				CHEVROLET	FAOU & LUB	

△ FULLY ORDER, SEALED & NOT STOPPED  
 0 0 0 0 1 7 0 0



General Motors Corporation  
CHEVROLET MOTOR DIVISION

PRODUCT DESCRIPTION MANUAL

ITEM REFERENCE    PROCESS MATERIAL    TORQUE    EXISTING AS PART OF

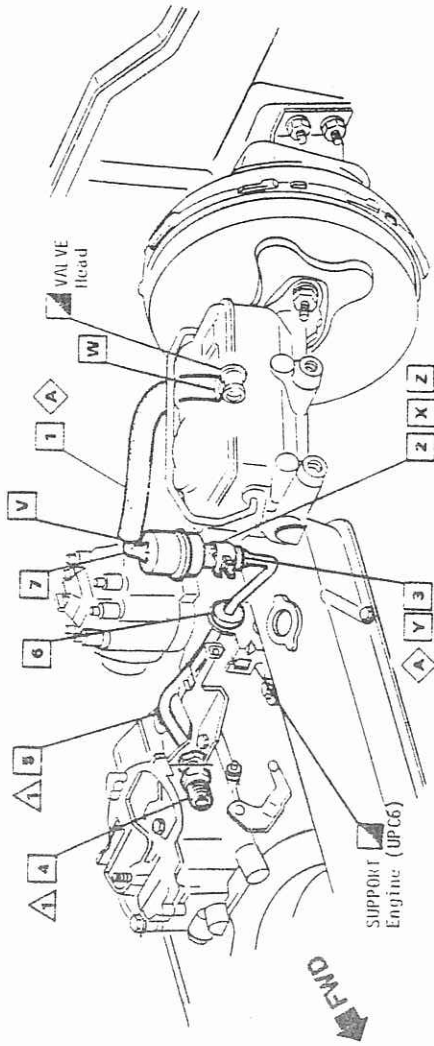
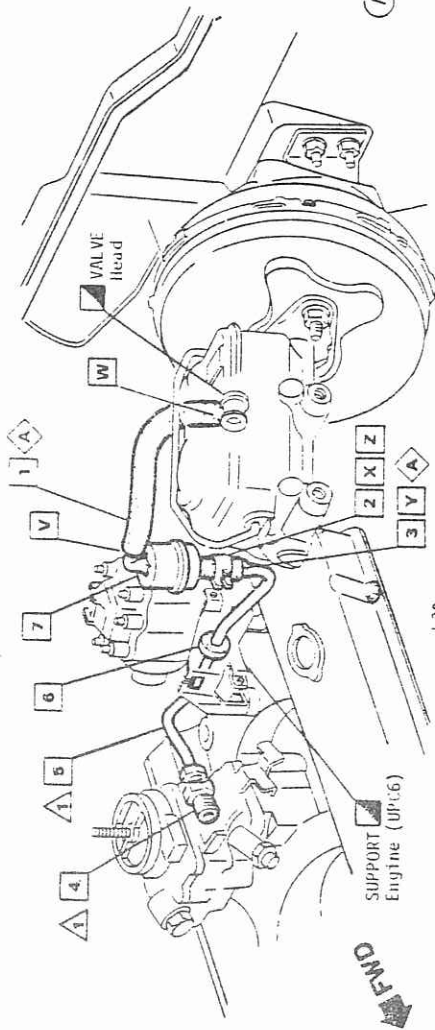

- 1 HOSE
- 2 CLAMP
- 3 HOSE
- 4 FITTING & L39
- 4 & LCA or LMI
- 5 TUBE ASM
- 6 GROMMET
- 7 FILTER ASM
- A LUB - RUBBER

Approx. .004 L per hose (both ends).

- V See Hose Installation instructions UPC 0A, Method K.
- W See Hose Installation instructions UPC 0A, Method H.
- X Install Clamp 2 so that the tangs of the Clamps are pointing away from the engine oil filler cap.
- Y See Clamping instructions UPC 0A, Method E.
- Z See Hose Installation instructions UPC 0A, Method L.

LCA OR LMI

DATE		REV		AUTH		DATE		DIV		TITLE	
11 - 14	17 APR 68	1	1	88756	1	11/11/68	CHEVROLET	1981 CHEV. "F" 14020867	VAC POWER BRAKE HOSES, PIPE & FILTER	FA00 & LCA/LMI/L39	
							ECR 86448	L-18920 S	UPC	5G	SHEET 4
							C/O 100E79				
							56-4				

FULLY DRIVEN, SEALED & NOT STRIPPED

A    B    C    D    E    F    G    H    I    J

PRODUCT DESCRIPTION MANUAL

BUICK MOTOR DIVISION  
GENERAL MOTORS CORPORATION FLINT, MICHIGAN

ITEM REFERENCE PROCESS MATERIAL TORQUE EXISTING AS PART OF

- 1 HOSE
- 2 FILTER
- 3 HOSE
- 4 TUBE ASH
- 5 CLAMP

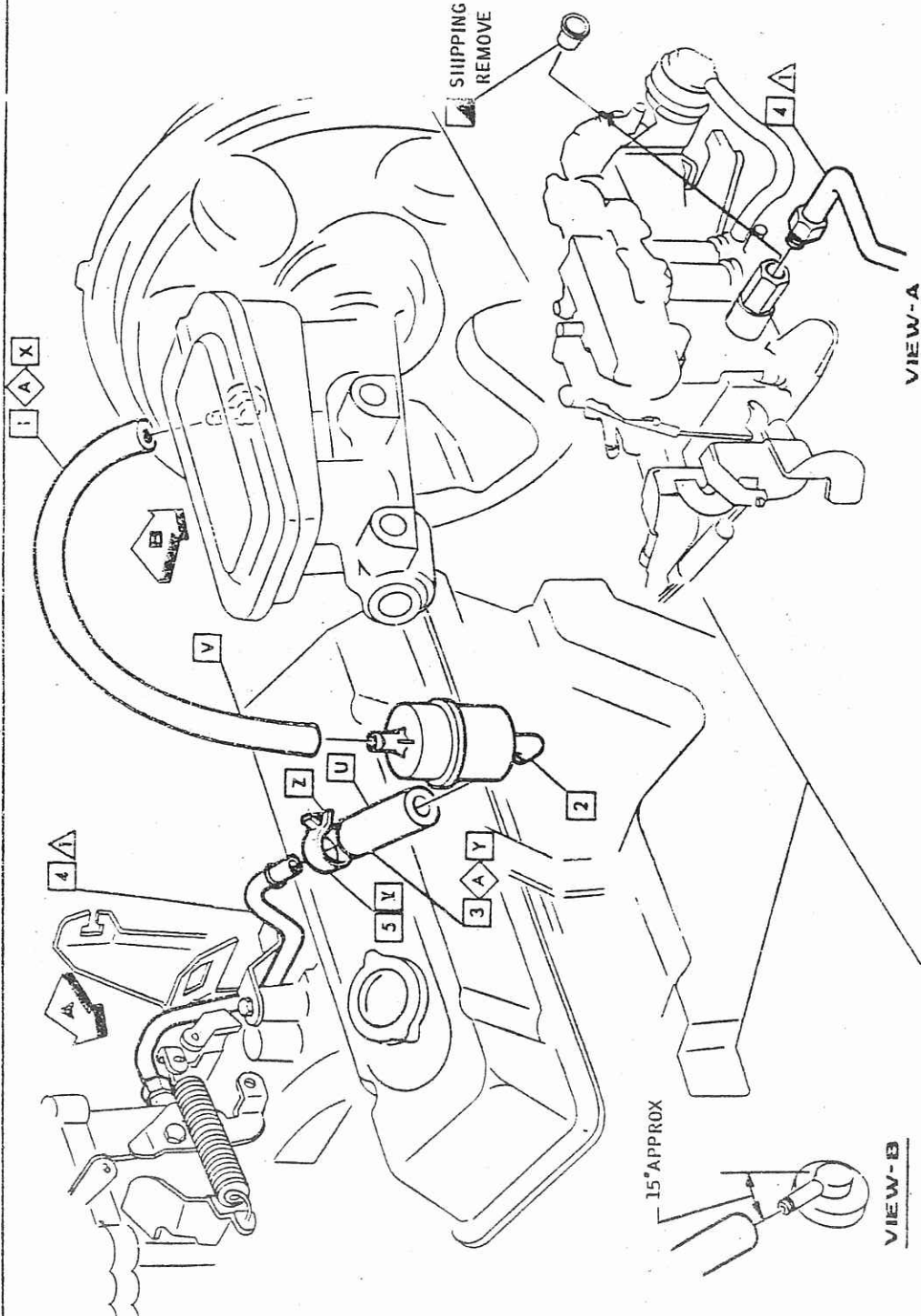

- A LUBRICANT(MAY BE USED TO ASSIST ASM OF TUBE)
- U SEE HOSE INSTALLATION INSTRUCTIONS UPC OA, METHOD K.
- V SEE HOSE INSTALLATION INSTRUCTIONS UPC OA, METHOD L.
- W SEE HOSE INSTALLATION INSTRUCTIONS UPC OA, METHOD H.
- X SEE HOSE INSTALLATION INSTRUCTIONS UPC OA, METHOD D.
- Y LOCATE CLAMP TANGS HORIZONTALLY.
- Z

VIEW-A

VIEW-B

1981 CHEV. "F" 14020867		TITLE	
CHEVROLET		VACUUM POWER BRAKE HOSE	
DIV		FAOD 84DS	
DATE	DRN079	ECR 86448	UIC
DR	DE BRIERLEY	NEW 28M80	SHEET
BY	CE R. Allen		5G
CHKD	APR 11/80		
APPV	APR 11/80		
APPV	APR 11/80		
ISSUED			
DATE	SYM		
11-16			
DYNAMIC (Instal, M, H, HAND (Insp.)) - Num		FULLY DRIVEN, SEATED & HOT STRIPPED	
G		G	





General Motors Corporation  
CHEVROLET MOTOR DIVISION

PRODUCT DESCRIPTION MANUAL  
 ITEM REFERENCE  PROCESS MATERIAL  TORQUE  EXISTING AS PART OF

TORQUE SPECIFICATIONS

All brake hydraulic system inverted flare type connections have a specified torque range of 20-27 N·m. It is permissible to torque fittings to a maximum of 27 N·m to repair system leaks. Fittings torqued above this limit shall require replacement of the mating components involved.

CLEARANCE INSTRUCTIONS

Brake lines and hoses must not be kinked, flattened, or bent out of designed position. In particular, unless covered by drawing specifications, lines must have at least 19.04mm clearance to any moving component (i.e. steering shaft, shift levers, etc.) and 12.7mm clearance to any vibrating part (i.e., underbody, power brake booster, etc.) unless it is specifically clipped to these components. There must be no evidence of hose twist.

DYNAMIC (Instal) N·m	HAND (Instal) N·m	DATE	SYM	REVISION	AUTM	DR	CE	DATE	DATE	DIV	TITLE	SHEET
△	△							11/18/80	11/18/80	CHEVROLET	1981 CHEV. "F" 14020867	1
△	△							DR 116 HOLDING/EM		CHEVROLET	BRAKE SYSTEM TORQUE & CLEARANCE INSTRUCTIONS	
△	△							(1) 11/18/80		REF ECK 86448	F400 ALL	
△	△							APPE 5		C/O 100E79		5Z
△	△							APPE		5Z-1		
△	△							APPE				
△	△							APPE				
△	△							APPE				

△ FULLY DRIVEN SEATED & NOT STRIPPED

Ch X B 0 P X Ca



General Motors Corporation  
CHEVROLET MOTOR DIVISION

**PRODUCT DESCRIPTION MANUAL**

ITEM REFERENCE  PROCESS MATERIAL  PROCEDURE  EXISTING AS PART OF

BRAKE SYSTEM BLEED CHECK

- OPTION-1** Brake Pedal Travel must not exceed 2.75 when a 100 LB force, is applied to the Brake Pedal Pad.
- OPTION-2** Push Rod Travel must not exceed 0.78 when a 350 LB force, is applied to the Push Rod.
- NOTE** Engine must be off and all vacuum exhausted from the booster on Power Brake vehicles before checks.

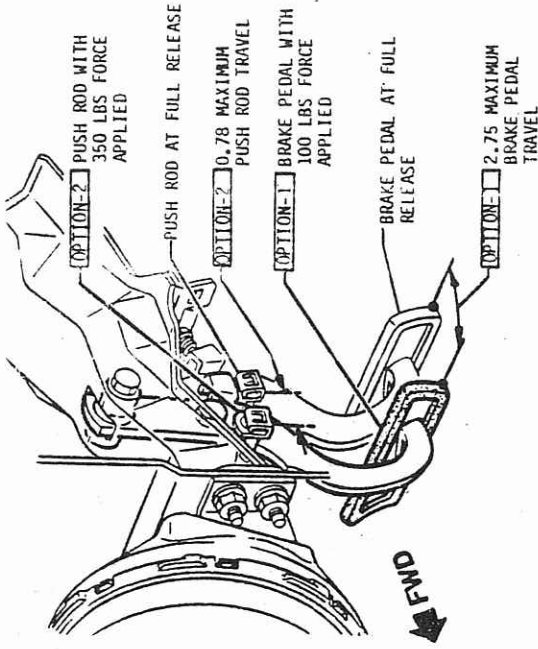

INDIVIDUAL WHEEL BRAKING EFFORT TEST-COMPLY WITH GM QUALITY/RELIABILITY STANDARD IQS-5-102

All cars to be checked on this equipment with a maximum deceleration of 15 ft/sec<sup>2</sup> from a maximum speed of 10 M.P.H. (recommended speed of 4 M.P.H.) make a permanent single punch record to show that the vehicle has passed the test.

**NOTE** This is a hard stop which would be considerably short of wheel slide on dry pavement, harder stops or fast apply rates may give indications of problems which do not really exist.

DATE	SYN	REVISION	AUTH	BR CK	DATE	DIV	TITLE
					08/15/74	CHEVROLET	1981 CHEV. "F" 14020867
					08/15/74	ECR 86448	BRAKE SYSTEM BLEED CHECK
					08/15/74	NEW 10DE79	FWD ALL
							UPC
							5Z
							SHEET
							2

△ FULLY DRIVEN, SEATED & NOT STRIPPED

0 0 0 0 0 0 0 0 0 0